

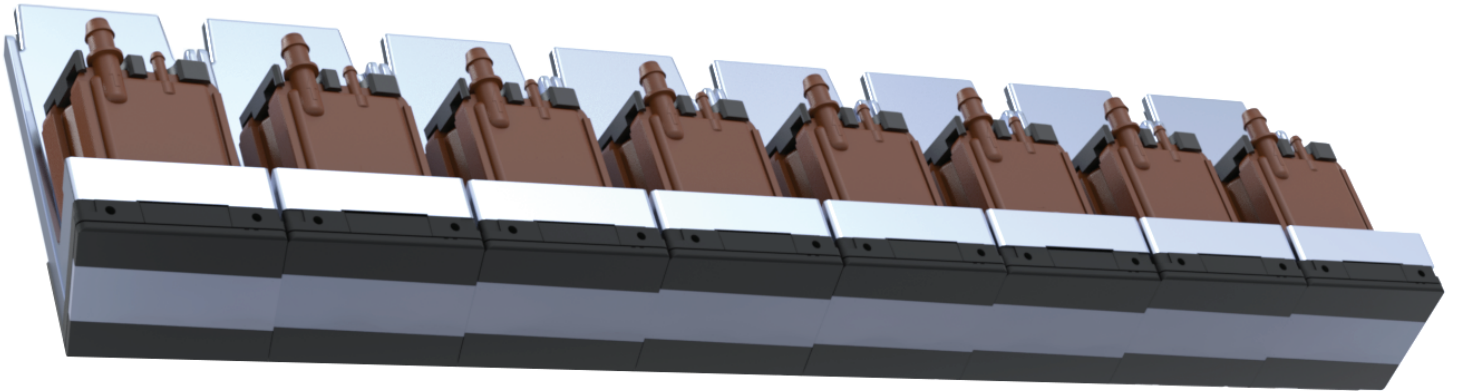

Samba®



Fujifilm's SAMBA® printhead technology provides the speed, versatility, and reliability suitable for a broad range of demanding graphics and specialty applications. The SAMBA printhead leverages the accuracy and precision of Silicon MEMS (Si-MEMS) processing with the reliability and useful life of sputtered PZT in an ingenious parallelogram shape to deliver breathtaking image quality at production speeds.

Unique Si-MEMS Design

- Superb drop placement accuracy and uniformity for high quality reproduction
- Broad fluid compatibility (UV, Aqueous, Solvent, Latex)
- Long useful life provided by sputtered PZT
- Broad ink latitude
- Multiple REDIJET® Coating (RJC) options including non-wetting coatings, internal protective coatings and hydrophobic coating to meet various application requirements
- Wide range of drop sizes

Optimized for Single Pass

- Parallelogram shape provides compact, in-line stitching for most print bar lengths
- High frequency with high duty cycle for challenging high flux applications
- Head design optimized for high standoffs
- 600 or 1200 dpi modes
- Grayscale for robust high-quality printing
- Fast priming and infrequent maintenance aided by multi-level ink recirculation



Proven Performance in Many Applications

The SAMBA printhead is the proven leader in high-speed applications such as Commercial Print, Textile, Label, Packaging, and 3D printing. Now the SAMBA family is expanding to include the G5L, bringing with it larger native drop size for single pass applications which demand even higher ink coverage.

Technical Specifications

Parameter	SAMBA G3L Printhead	SAMBA G5L Printhead
Number of addressable Jets per module	2048	2048
Print width	43 mm (1.7 in)	43 mm (1.7 in)
Native resolution	1200 dpi (600 redundant)	1200 dpi (600 redundant)
Firing frequency	Over 100 kHz	Over 100 kHz
Compatible fluids	UV, AQ, Latex, Solvents, Other	AQ, Latex, Solvents, Other
Printhead heating	Fluid thermal transfer	Fluid thermal transfer
Inkjet operating temperature range	Up to 60° C (140° F)	Up to 60° C (140° F)
Nozzle plate technology	Silicon MEMS w/ protective REDIJET coating	Silicon MEMS w/ protective REDIJET coating
PZT technology	MEMS sputtered PZT	MEMS sputtered PZT
Max productivity	360 ng-kHz	450 ng-kHz
Native drop size	2.4 pL	3.5 pL
Largest drop size	10 pL	13 pL
Viscosity range	4 - 8 cPs	5 - 9 cPs
Temperature sensor	Built-in thermistor	Built-in thermistor

Productivity

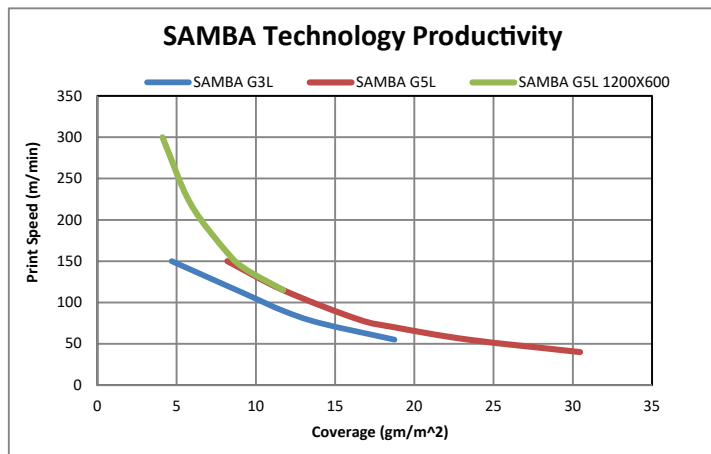

Physical Characteristics

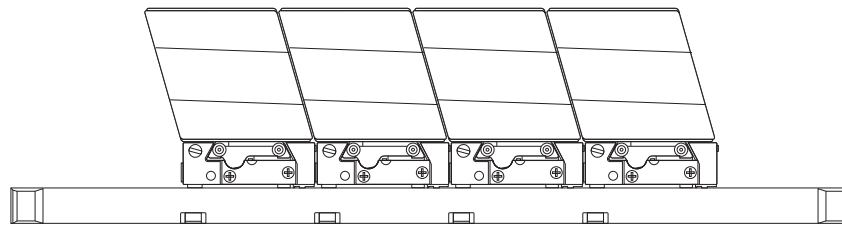
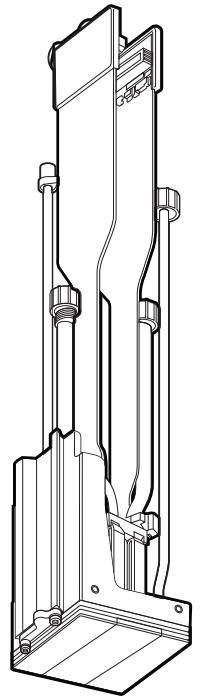
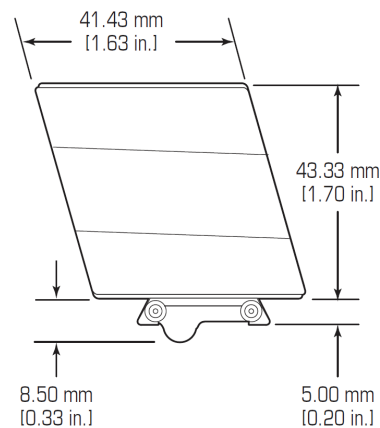

Scan the QRcode for additional information

Product data presented above are for guideline purposes only. For technical support please contact Dimatix for the appropriate Product Manual containing full Product Specifications.

FUJIFILM



Corporate Office:
FUJIFILM Dimatix, Inc.
2250 Martin Avenue
Santa Clara, CA 95050
USA
Tel: 1 (408) 565-9150
Email: info@dimatix.com

New Hampshire Facility:
FUJIFILM Dimatix, Inc.
109 Etna Road
Lebanon, NH 03766
USA
Tel: 1 (603) 443-5300
Email: info@dimatix.com

Inkjet Business Division:
FUJIFILM Corporation
Fujifilm Nishiazabu Bldg.,
2-26-30 Nishiazabu
Minato-ku, Tokyo 106-0031 Japan
Tel: +81 3 6419 0530
Email: ff-inkjet@fujifilm.com

China Office:
FUJIFILM Dimatix China Service Center
Building 30, 1000 Jinhai Road
Pudong New Area, Shanghai
China 201206
Email: china@dimatix.com

Europe Office:
Email: euro@dimatix.com

Korea Office:
Email: mdkorea@dimatix.com

Singapore Office:
Email: mdsingapore@dimatix.com

Taiwan Office:
Email: mdtaiwan@dimatix.com

FUJIFILM and the FUJIFILM logo, DIMATIX, SAMBA and the SAMBA logo are trademarks of FUJIFILM Corporation and its affiliates.
© 2022 FUJIFILM Dimatix, Inc. All rights reserved.